

ELECTRIC PLANETARY HOISTS

DC500

1100 lbs Capacity

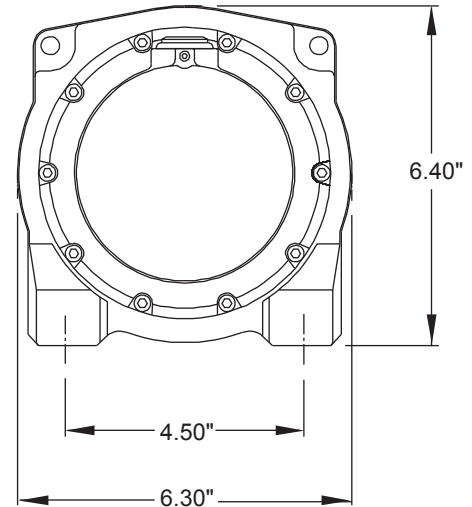
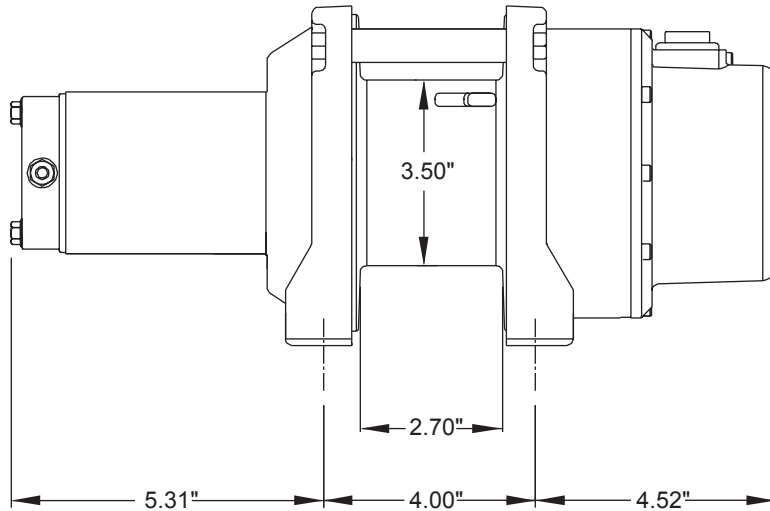

FEATURES

- Compact Design
- 3-Stage Planetary Reduction
- Automatic, Load-Suspending Brake
- Simple Wire Rope Attachment
- Rated for Hoisting
- Conforms to CE Requirements

Wire Rope Capacity

3/16"
99'

PERFORMANCE

Specifications			Multi-Layer Performance			First Layer Performance		
Motor Type	Motor HP	Shipping Weight	Layer	Load (lbs)	Speed (fpm)	Load (lbs)	Speed (fpm)	Amp Draw
12V	1.1	25 lbs	1	1100	16.9	0	6.5	38
			2	965	19.3	500	5.9	65
			3	859	21.6	750	5.6	78
			4	775	24.0	1100	5.2	99
24V	1.1	25 lbs	1	1100	16.9	0	6.5	13
			2	965	19.3	500	5.9	34
			3	859	21.6	750	5.6	45
			4	775	24.0	1100	5.2	55

Performance based on intermittent duty cycles.

CAUTION: The final determination as to the suitability of this product for any purpose is solely that of the user. These products are not to be used to lift people or to lift anything over people.

ALLIED POWER PRODUCTS, INC.

THE WINCH & HOIST SPECIALISTS

6590 SW Fallbrook Place, Beaverton, OR 97008

(503) 626-0654 Fax (503) 646-1996

www.alliedpower.com